

FRONT VIEW
TOP RIGHT TERMINAL COVER HIDDEN

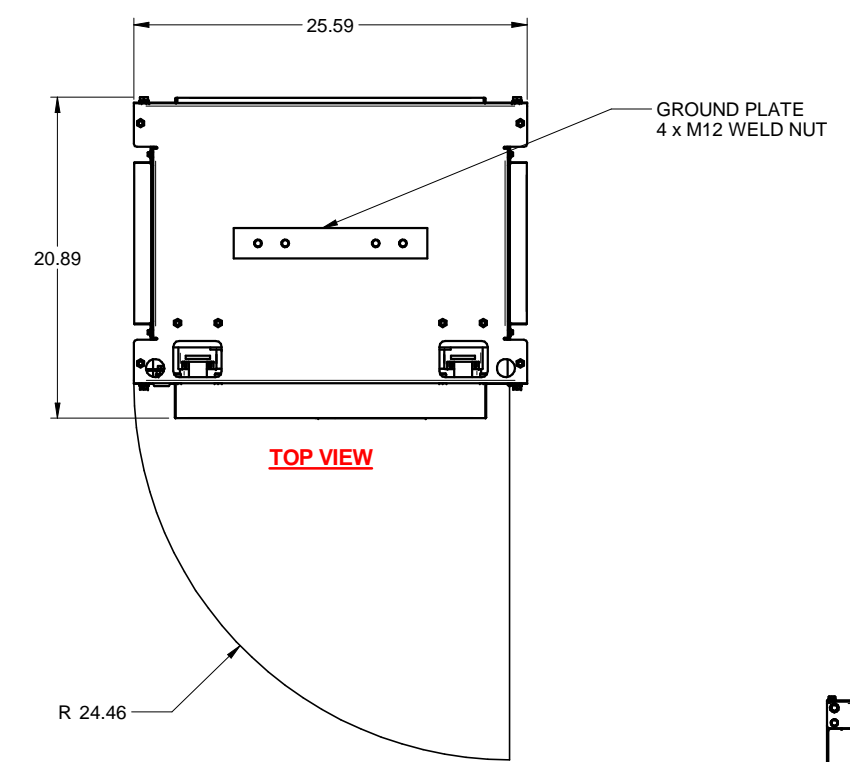

TOP VIEW

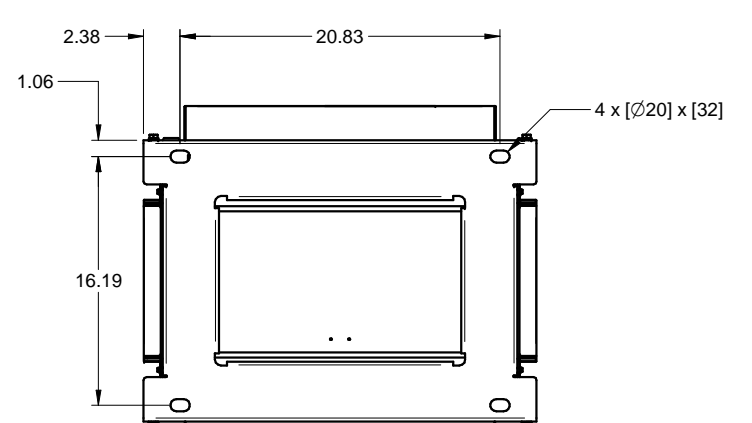

BOTTOM VIEW

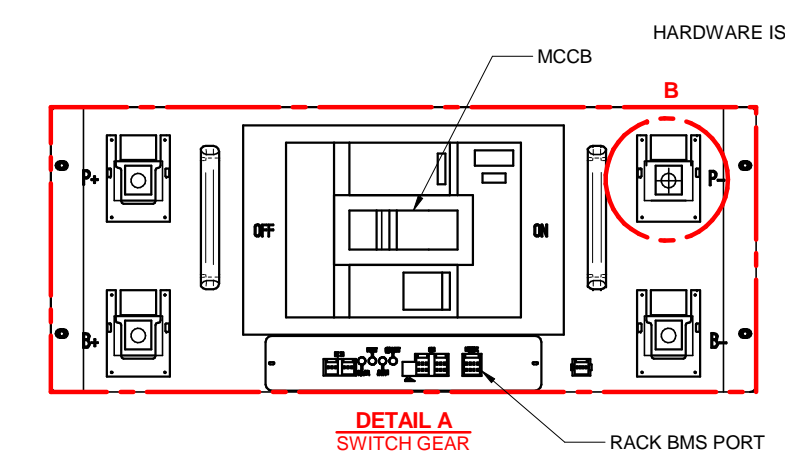

DETAIL A
SWITCH GEAR

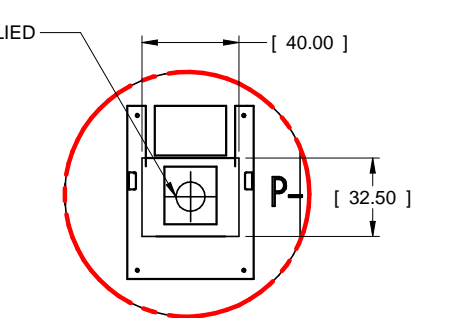

DETAIL B
APPLIES TO BOTH TOP TERMINALS

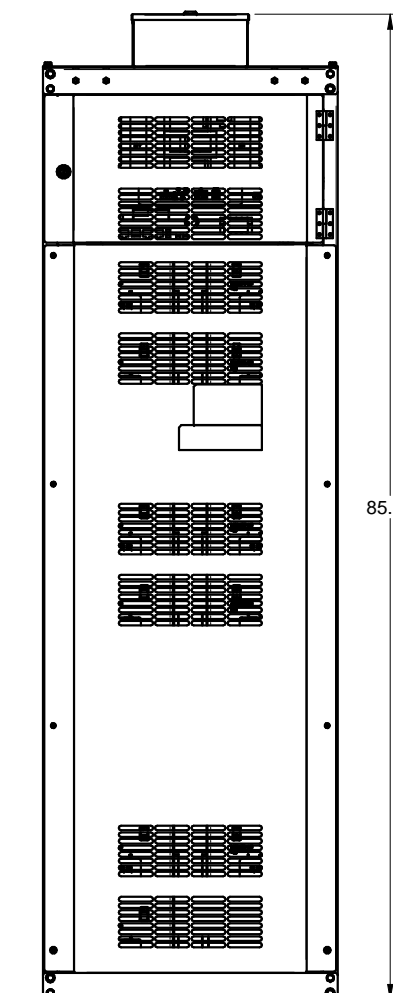

BCL04 WITH I/O SIGNAL INTERFACE BOX
-1 PER SYSTEM
- UA-100745

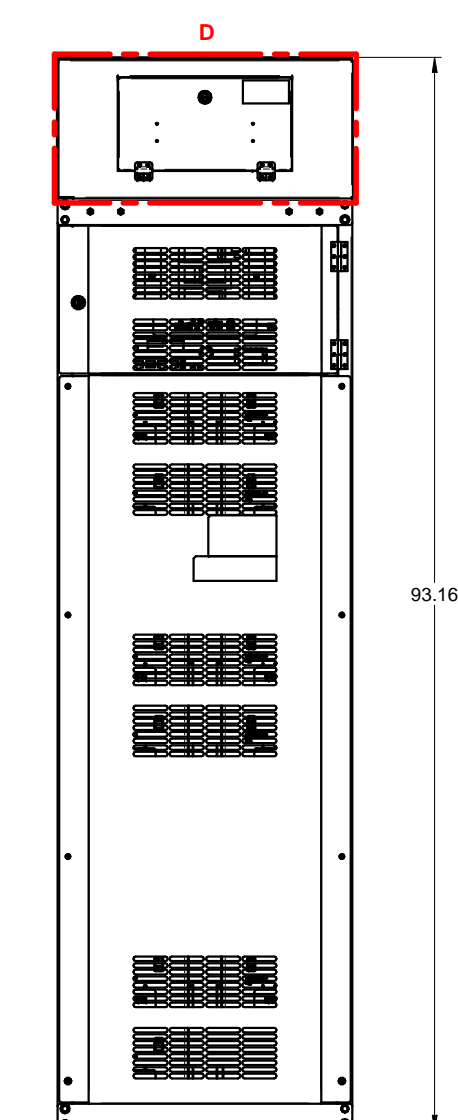

BCL04 WITH TOPHAT
-1 PER RACK
-I/O SIGNAL INTERFACE LOCATED IN MASTER RACK (1 PER SYSTEM)
-UA-100583

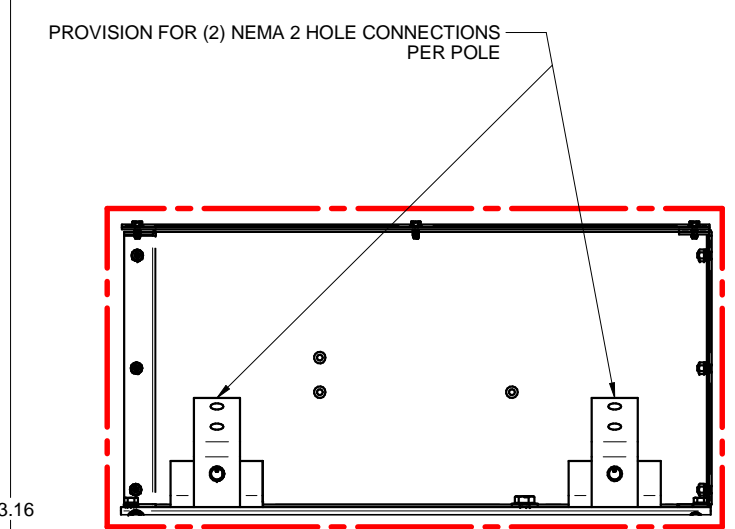

DETAIL D
FRONT PANEL HIDDEN

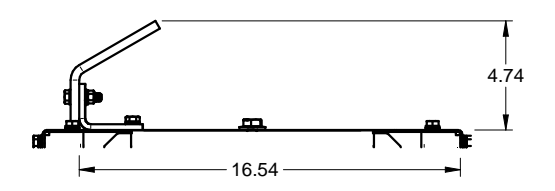

BUSS TABS SIDE ELEVATION
TOPHAT HIDDEN

- NOTES:
1. REDUNDANT CONTROL POWER SUPPLIES, 100-240VAC, 1 PHASE + GROUND. (SUPPLIED AND INSTALLED BY OTHERS)
 2. 8 SIGNAL WIRES REQUIRED (6 SIGNAL WIRES FOR 9900C/CX) 22-16 AWG WIRE SIZE. (SUPPLIED AND INSTALLED BY OTHERS)
 3. RACK SPECIFICATIONS:
184KW CONTINUOUS, 257KW MAX POWER
340-582 VDC OPERATING VOLTAGE RANGE (PROTECTION LIMIT)
 4. ALL FOUR CORNERS OF EVERY CABINET SHALL BE ANCHORED TO FLOOR.
 5. APPLY "NO-OX" GREASE TO BATTERY TERMINALS.
 6. I/O SIGNAL INTERFACE BOX AND TOP HAT ARE FIELD INSTALLED ITEMS

BCL04

REVISIONS	DATE	BY	DESCRIPTION
0. INITIAL RELEASE	05/01/2019	E.MACDONALD	
1. CHANGED CABINET TYPE: UPDATED PER ECN 1396	07/17/2019	Z.ZAJAC	
2. CHANGED TITLE AND LABELING TO BCL04; UPDATED PER ECN 1511	09/25/19	Z.ZAJAC	
4. ADDED VIEWS AND NOTE 4 & 5 TO SHEET 1	1/23/2020	Z.ZAJAC	
5. UPDATED VIEWS, ADDED OVERALLS. J.PRY-SOCK	2/11/2020		

DIMENSIONS IN: IN [MM] (REF)	SCALE - NTS -	DRAFTER Z.ZAJAC	DATE 10/30/19	
<small>PROPRIETARY</small> This document is the property of Mitsubishi Electric Power Products, Inc. and contains proprietary and confidential information which must not be duplicated, used or disclosed other than as expressly authorized by Mitsubishi Electric Power Products, Inc.		APPROVED A.WINTERS	DATE 10/30/19	
CORE/REFERENCE DRAWING (IF APPLICABLE)		TITLE BCL04 LITHIUM BATTERY CABINET		
DWG. NO. UD-100945		SHEET 1 OF 2		REV. 5

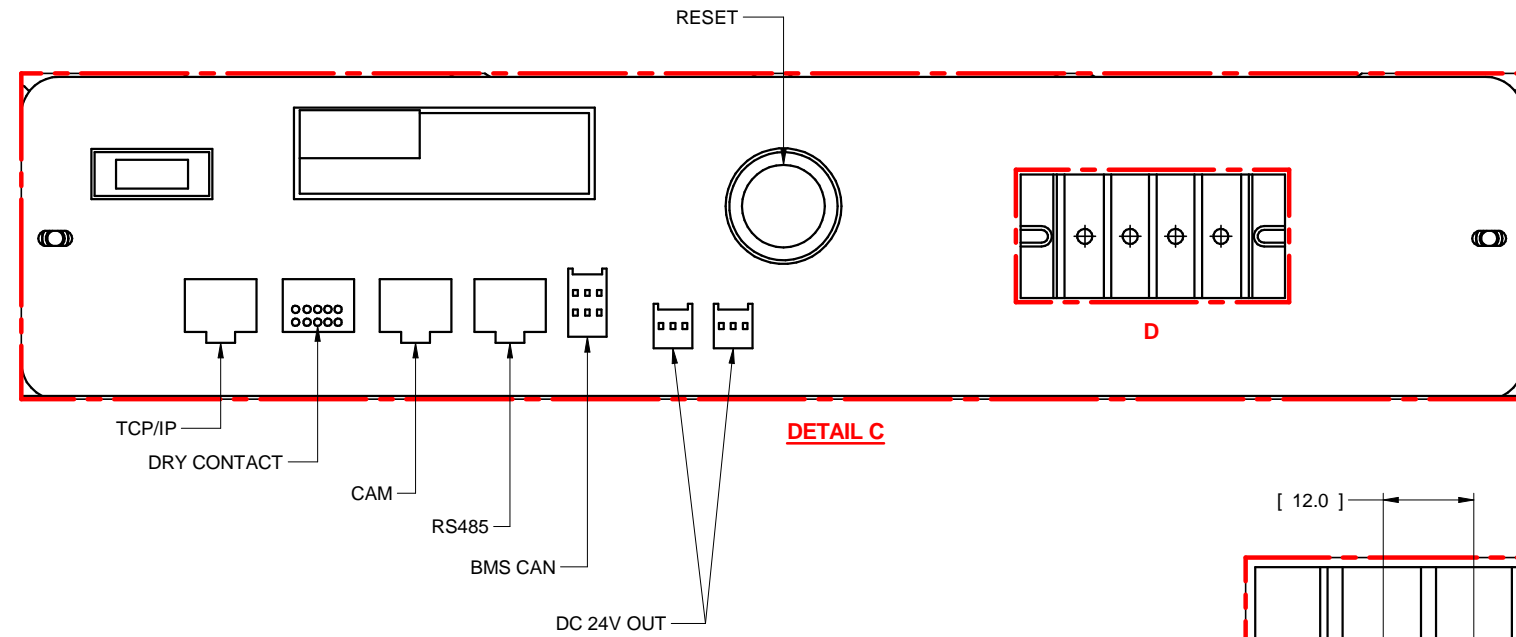

DETAIL C

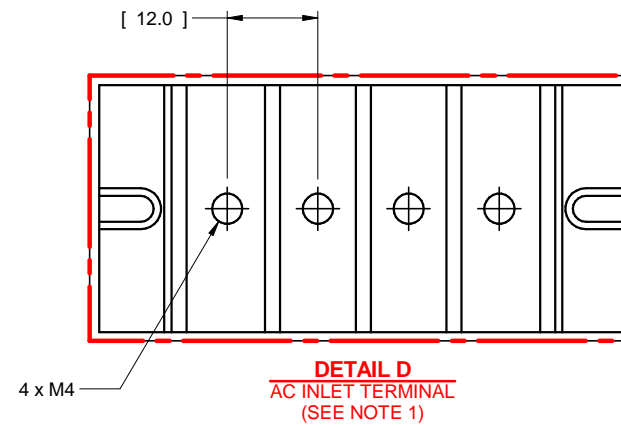

SYSTEM BMS

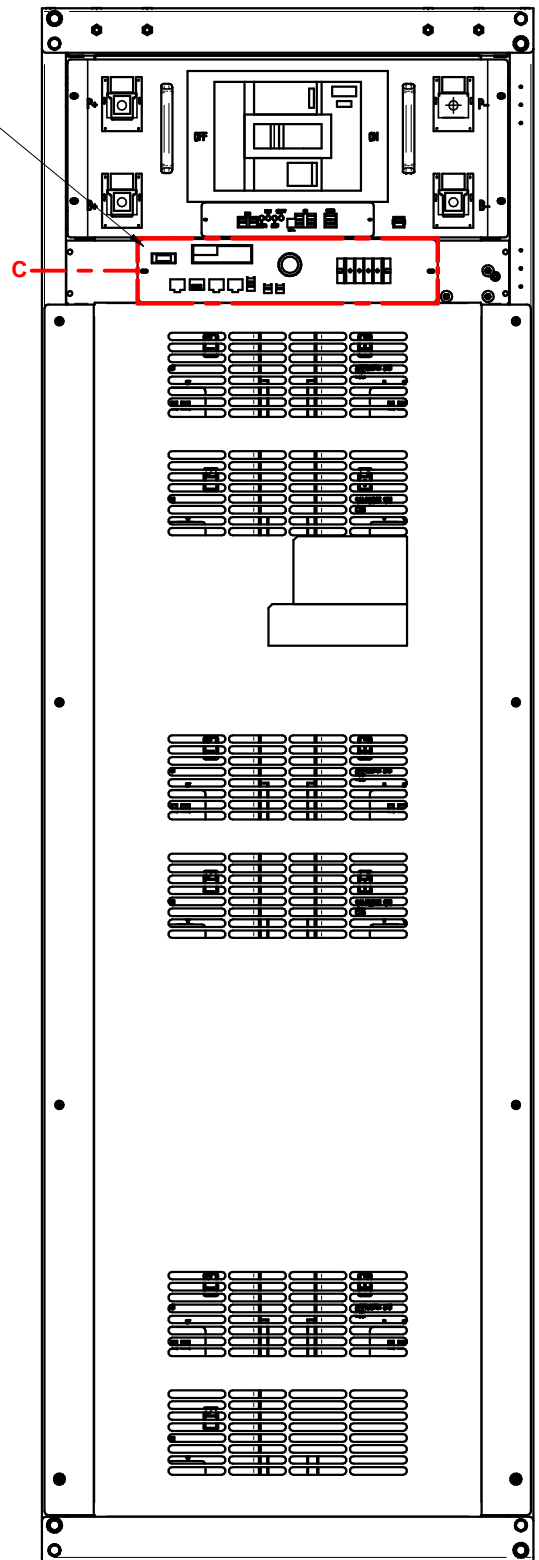

TYPICAL SIGNAL CONNECTIONS TO UPS
SEE NOTE 2

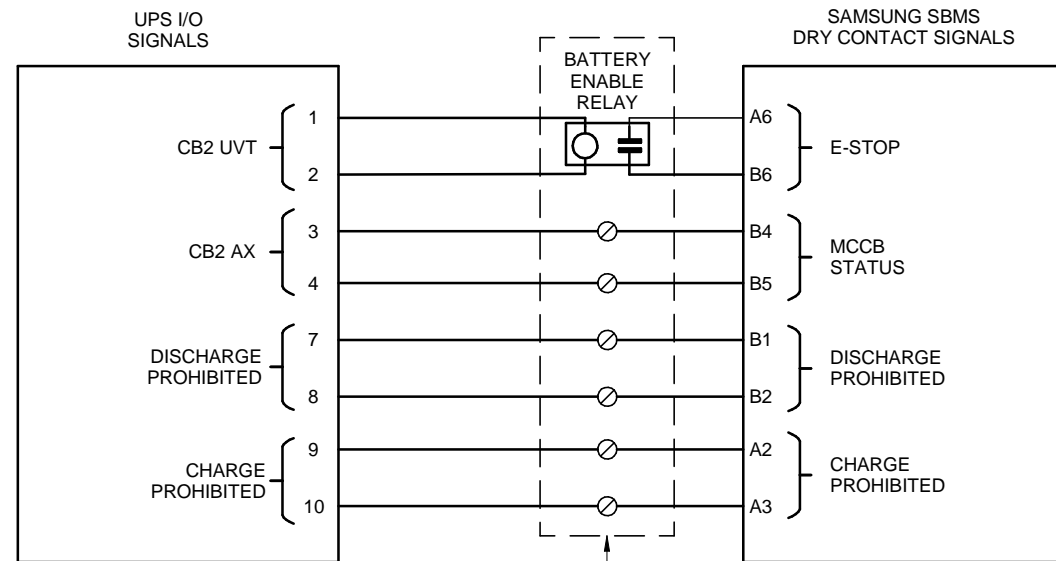

LOCATED IN TOPHATE OR I/O SIGNAL INTERFACE BOX

SYSTEM BMS INTERFACE

REVISIONS
0. INITIAL RELEASE ECN 1256 E.MACDONALD 05/01/2019
1. CHANGED CABINET TYPE: UPDATED PER ECN 1396 Z.ZAJAC 7/17/2019
2. CHANGED TITLE AND LABELING TO BCL04; UPDATED PER ECN 1511 Z.ZAJAC 9/25/19
4. ADDED VIEWS AND NOTE 4 & 5 TO SHEET 1 Z.ZAJAC 1/23/2020
5. UPDATED VIEWS, ADDED OVERALLS. J.PRY-SOCK 2/11/2020

DIMENSIONS IN: IN [MM] (REF)	SCALE - NTS -	DRAFTER Z.ZAJAC	DATE 10/30/19	<p>MITSUBISHI ELECTRIC</p>
<p>PROPRIETARY This document is the property of Mitsubishi Electric Power Products, Inc. and contains proprietary and confidential information which must not be duplicated, used or disclosed other than as expressly authorized by Mitsubishi Electric Power Products, Inc.</p>		APPROVED A.WINTERS	DATE 10/30/19	
CORE/REFERENCE DRAWING (IF APPLICABLE)		TITLE BCL04 LITHIUM BATTERY CABINET		DWG. NO. UD-100945
		SHEET 2 OF 2		REV. 5